

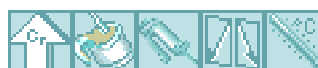

Yoke type track rollers NATR..-PP

with axial guidance, axial plain washers on both sides

The datasheet is only an overview of dimensions and basic load ratings for the selected series. Please ensure that you note all the guidance in these overview pages. Further information is given on many products under the menu item "Description". You can also obtain comprehensive information material via Catalogue selection (<http://www.ina.de/content.ina.de/en/services/mediathek/library/library.jsp>), by e-mail (kataloge@de.ina.com) or telephone +49 (91 32) 82 - 28 97.

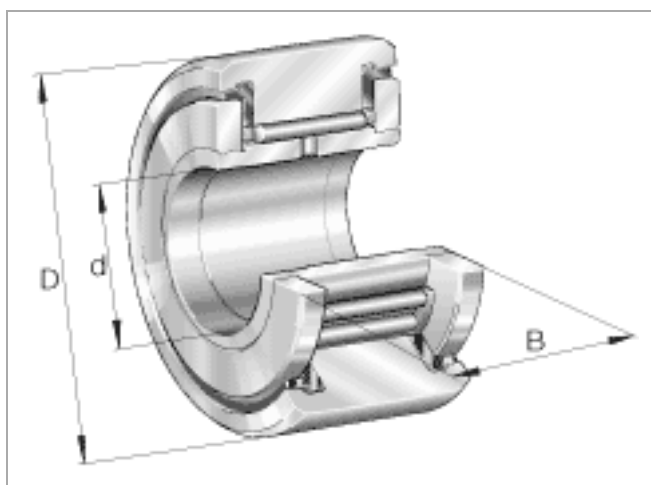

| | d mm | D mm | B mm |
|-----------|---------|---------|---------|
| NATR5-PP | 5 | 16 | 12 |
| NATR6-PP | 6 | 19 | 12 |
| NATR8-PP | 8 | 24 | 15 |
| NATR10-PP | 10 | 30 | 15 |
| NATR12-PP | 12 | 32 | 15 |
| NATR15-PP | 15 | 35 | 19 |
| NATR17-PP | 17 | 40 | 21 |
| NATR20-PP | 20 | 47 | 25 |
| NATR25-PP | 25 | 52 | 25 |
| NATR30-PP | 30 | 62 | 29 |
| NATR35-PP | 35 | 72 | 29 |
| NATR40-PP | 40 | 80 | 32 |
| NATR50-PP | 50 | 90 | 32 |
| | d mm | D mm | B mm |



Figure 1

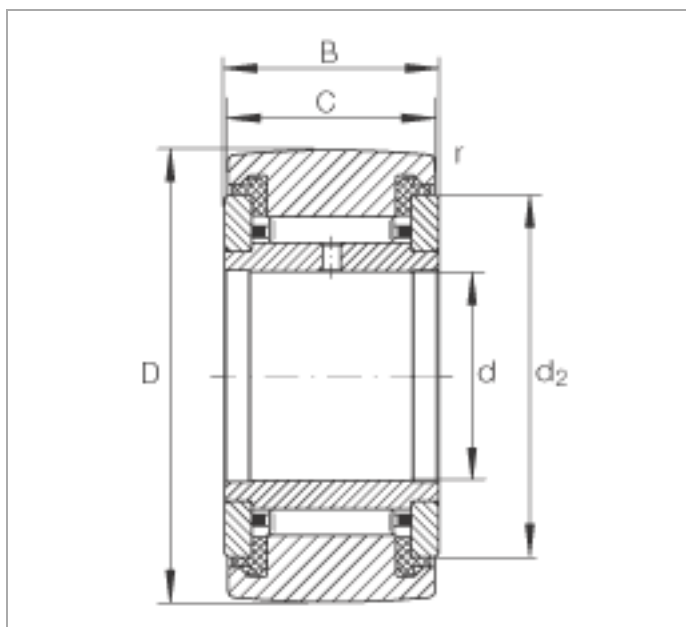

NATR5-PP

| | | |
|-------------------|-------------|---|
| d | 5 mm | |
| D | 16 mm | |
| B | 12 mm | |
| C | 11 mm | |
| d ₂ | 12,5 mm | |
| r _{min} | 0,15 mm | |
| m | 14 g | Mass |
| C _{r w} | 3150 N | Effective dynamic load rating as track roller (radial) |
| C _{0r w} | 3350 N | Effective static load rating as track roller (radial) |
| C _{ur w} | 450 N | Fatigue limit load |
| n _{D G} | 14000 1/min | Speed (with continuous operation and grease lubrication) |
| | | Bearing with plastic axial plain washers and optimised INA profile. |
| | | Permissible operating temperature: -30°C to + 100°C (continuous operation). |

NATR6-PP

| | | |
|-------------------|-------------|---|
| d | 6 mm | |
| D | 19 mm | |
| B | 12 mm | |
| C | 11 mm | |
| d ₂ | 15 mm | |
| r _{min} | 0,15 mm | |
| m | 19 g | Mass |
| C _{r w} | 3500 N | Effective dynamic load rating as track roller (radial) |
| C _{0r w} | 4000 N | Effective static load rating as track roller (radial) |
| C _{ur w} | 540 N | Fatigue limit load |
| n _{D G} | 11000 1/min | Speed (with continuous operation and grease lubrication) |
| | | Bearing with plastic axial plain washers and optimised INA profile. |
| | | Permissible operating temperature: -30°C to + 100°C (continuous operation). |

NATR8-PP

| | | |
|-------------------|------------|---|
| d | 8 mm | |
| D | 24 mm | |
| B | 15 mm | |
| C | 14 mm | |
| d ₂ | 19 mm | |
| r _{min} | 0,3 mm | |
| m | 38 g | Mass |
| C _{r w} | 5500 N | Effective dynamic load rating as track roller (radial) |
| C _{0r w} | 6600 N | Effective static load rating as track roller (radial) |
| C _{ur w} | 930 N | Fatigue limit load |
| n _{D G} | 7500 1/min | Speed (with continuous operation and grease lubrication) |
| | | Bearing with plastic axial plain washers and optimised INA profile. |
| | | Permissible operating temperature: -30°C to + 100°C (continuous operation). |

NATR10-PP

| | | |
|-------------------|------------|---|
| d | 10 mm | |
| D | 30 mm | |
| B | 15 mm | |
| C | 14 mm | |
| d ₂ | 23 mm | |
| r _{min} | 0,6 mm | |
| m | 64 g | Mass |
| C _{r w} | 6800 N | Effective dynamic load rating as track roller (radial) |
| C _{0r w} | 8600 N | Effective static load rating as track roller (radial) |
| C _{ur w} | 1220 N | Fatigue limit load |
| n _{D G} | 5500 1/min | Speed (with continuous operation and grease lubrication) |
| | | Bearing with plastic axial plain washers and optimised INA profile. |
| | | Permissible operating temperature: -30°C to + 100°C (continuous operation). |

NATR12-PP

| | | |
|-------------------|------------|---|
| d | 12 mm | |
| D | 32 mm | |
| B | 15 mm | |
| C | 14 mm | |
| d ₂ | 25 mm | |
| r _{min} | 0,6 mm | |
| m | 66 g | Mass |
| C _{r w} | 7000 N | Effective dynamic load rating as track roller (radial) |
| C _{0r w} | 9000 N | Effective static load rating as track roller (radial) |
| C _{ur w} | 1290 N | Fatigue limit load |
| n _{D G} | 4500 1/min | Speed (with continuous operation and grease lubrication) |
| | | Bearing with plastic axial plain washers and optimised INA profile. |
| | | Permissible operating temperature: -30°C to + 100°C (continuous operation). |

NATR15-PP

| | | |
|-------------------|------------|---|
| d | 15 mm | |
| D | 35 mm | |
| B | 19 mm | |
| C | 18 mm | |
| d ₂ | 27,6 mm | |
| r _{min} | 0,6 mm | |
| m | 95 g | Mass |
| C _{r w} | 9700 N | Effective dynamic load rating as track roller (radial) |
| C _{0r w} | 14300 N | Effective static load rating as track roller (radial) |
| C _{ur w} | 1830 N | Fatigue limit load |
| n _{D G} | 3600 1/min | Speed (with continuous operation and grease lubrication) |
| | | Bearing with plastic axial plain washers and optimised INA profile. |
| | | Permissible operating temperature: -30°C to + 100°C (continuous operation). |

NATR17-PP

| | | |
|-------------------|------------|---|
| d | 17 mm | |
| D | 40 mm | |
| B | 21 mm | |
| C | 20 mm | |
| d ₂ | 31,5 mm | |
| r _{min} | 1 mm | |
| m | 139 g | Mass |
| C _{r w} | 10900 N | Effective dynamic load rating as track roller (radial) |
| C _{0r w} | 15800 N | Effective static load rating as track roller (radial) |
| C _{ur w} | 2090 N | Fatigue limit load |
| n _{D G} | 2900 1/min | Speed (with continuous operation and grease lubrication) |
| | | Bearing with plastic axial plain washers and optimised INA profile. |
| | | Permissible operating temperature: -30°C to + 100°C (continuous operation). |

NATR20-PP

| | | |
|-------------------|------------|---|
| d | 20 mm | |
| D | 47 mm | |
| B | 25 mm | |
| C | 24 mm | |
| d ₂ | 36,5 mm | |
| r _{min} | 1 mm | |
| m | 236 g | Mass |
| C _{r w} | 15400 N | Effective dynamic load rating as track roller (radial) |
| C _{0r w} | 26000 N | Effective static load rating as track roller (radial) |
| C _{ur w} | 3400 N | Fatigue limit load |
| n _{D G} | 2400 1/min | Speed (with continuous operation and grease lubrication) |
| | | Bearing with plastic axial plain washers and optimised INA profile. |
| | | Permissible operating temperature: -30°C to + 100°C (continuous operation). |

NATR25-PP

| | | |
|-------------------|------------|---|
| d | 25 mm | |
| D | 52 mm | |
| B | 25 mm | |
| C | 24 mm | |
| d ₂ | 41,5 mm | |
| r _{min} | 1 mm | |
| m | 271 g | Mass |
| C _{r w} | 15300 N | Effective dynamic load rating as track roller (radial) |
| C _{0r w} | 27000 N | Effective static load rating as track roller (radial) |
| C _{ur w} | 3550 N | Fatigue limit load |
| n _{D G} | 1800 1/min | Speed (with continuous operation and grease lubrication) |
| | | Bearing with plastic axial plain washers and optimised INA profile. |
| | | Permissible operating temperature: -30°C to + 100°C (continuous operation). |

NATR30-PP

| | | |
|-------------------|------------|---|
| d | 30 mm | |
| D | 62 mm | |
| B | 29 mm | |
| C | 28 mm | |
| d ₂ | 51 mm | |
| r _{min} | 1 mm | |
| m | 444 g | Mass |
| C _{r w} | 23200 N | Effective dynamic load rating as track roller (radial) |
| C _{0r w} | 39000 N | Effective static load rating as track roller (radial) |
| C _{ur w} | 5200 N | Fatigue limit load |
| n _{D G} | 1300 1/min | Speed (with continuous operation and grease lubrication) |
| | | Bearing with plastic axial plain washers and optimised INA profile. |
| | | Permissible operating temperature: -30°C to + 100°C (continuous operation). |

NATR35-PP

| | | |
|-------------------|------------|---|
| d | 35 mm | |
| D | 72 mm | |
| B | 29 mm | |
| C | 28 mm | |
| d ₂ | 58 mm | |
| r _{min} | 1,1 mm | |
| m | 547 g | Mass |
| C _{r w} | 24800 N | Effective dynamic load rating as track roller (radial) |
| C _{0r w} | 44500 N | Effective static load rating as track roller (radial) |
| C _{ur w} | 5900 N | Fatigue limit load |
| n _{D G} | 1000 1/min | Speed (with continuous operation and grease lubrication) |
| | | Bearing with plastic axial plain washers and optimised INA profile. |
| | | Permissible operating temperature: -30°C to + 100°C (continuous operation). |

NATR40-PP

| | | |
|-------------------|-----------|---|
| d | 40 mm | |
| D | 80 mm | |
| B | 32 mm | |
| C | 30 mm | |
| d ₂ | 66 mm | |
| r _{min} | 1,1 mm | |
| m | 795 g | Mass |
| C _{r w} | 32000 N | Effective dynamic load rating as track roller (radial) |
| C _{0r w} | 58000 N | Effective static load rating as track roller (radial) |
| C _{ur w} | 8300 N | Fatigue limit load |
| n _{D G} | 850 1/min | Speed (with continuous operation and grease lubrication) |
| | | Bearing with plastic axial plain washers and optimised INA profile. |
| | | Permissible operating temperature: -30°C to + 100°C (continuous operation). |

NATR50-PP

| | | |
|--------------------|-----------|---|
| d | 50 mm | |
| D | 90 mm | |
| B | 32 mm | |
| C | 30 mm | |
| d ₂ | 76 mm | |
| r _{min} | 1,1 mm | |
| m | 867 g | Mass |
| C _{r w} | 31000 N | Effective dynamic load rating as track roller (radial) |
| C _{0 r w} | 59000 N | Effective static load rating as track roller (radial) |
| C _{ur w} | 8400 N | Fatigue limit load |
| n _{D G} | 650 1/min | Speed (with continuous operation and grease lubrication) |
| | | Bearing with plastic axial plain washers and optimised INA profile. |
| | | Permissible operating temperature: -30°C to + 100°C (continuous operation). |