

### Deep groove ball bearings, single row, low-friction seal on both sides

Principal dimensions			Basic load ratings		Fatigue load limit $P_u$	Speed ratings		Mass	Designation
d	D	B	dynamic	static		Reference speed	Limiting speed		
mm			kN		kN	r/min		kg	-
20	52	15	16,8	7,8	0,335	30000	15000	0,14	6304-2RSL *

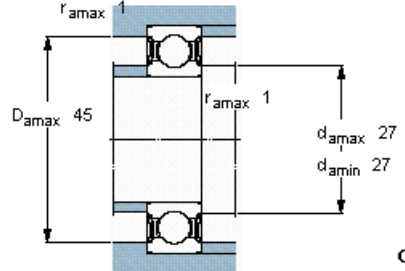
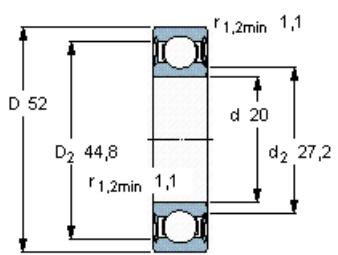

**Calculation factors**

$k_r = 0,03$   
 $f_0 = 12$